

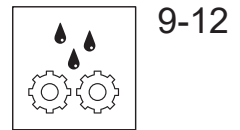

Oras

Installation and maintenance guide

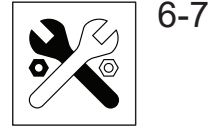



1870G

I (ISO 3822)
 EN 817
 50 - 1000 kPa
 0.16 l/s (Eco)
 0.26 l/s (300 kPa)
 0.2 l/s (300 kPa w/Reducer)
 180 kPa (0.2 l/s)
 300 kPa (0.2 l/s w/Reducer)
 max. +80°C

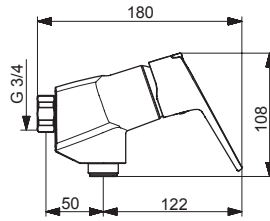
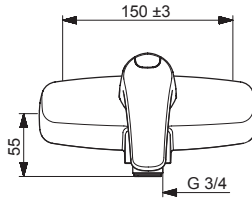

mpi.oras.com/1870G

1875G

I (ISO 3822)
 EN 817
 50 - 1000 kPa
 0.16 l/s (Eco)
 0.26 l/s (300 kPa)
 0.2 l/s (300 kPa w/Reducer)
 180 kPa (0.2 l/s)
 300 kPa (0.2 l/s w/Reducer)
 max. +80°C

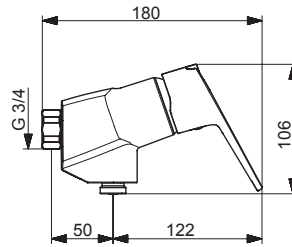
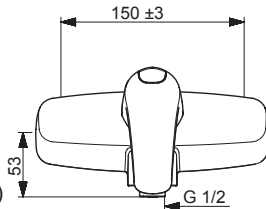

mpi.oras.com/1875G

1840G

I (ISO 3822)
 EN 817
 50 - 1000 kPa
 0.19 l/s (Eco)
 0.33 l/s (300 kPa)
 160 kPa (0.2 l/s)
 295 kPa (0.3 l/s)
 max. +80°C

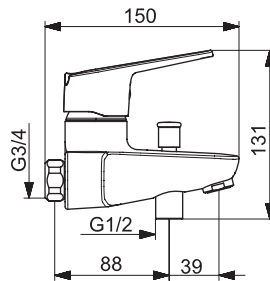
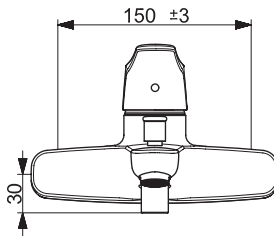

mpi.oras.com/1840G

1871G

I (ISO 3822)
 EN 817
 50 - 1000 kPa
 0.19 l/s (Eco)
 0.33 l/s (300 kPa)
 0.2 l/s (300 kPa w/Reducer)
 160 kPa (0.2 l/s)
 260 kPa (0.3 l/s)
 300 kPa (0.2 l/s w/Reducer)
 max. +80°C

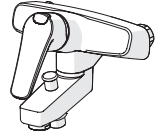
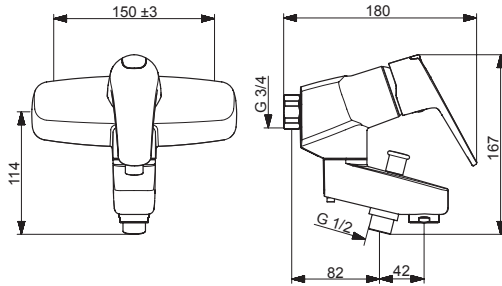

mpi.oras.com/1871G

1878G

I (ISO 3822)
 EN 817, EN 1112, EN 1113
 50 - 1000 kPa
 0.19 l/s (Eco)
 0.33 l/s (300 kPa)
 0.2 l/s (300 kPa w/Reducer)
 160 kPa (0.2 l/s)
 260 kPa (0.3 l/s)
 300 kPa (0.2 l/s w/Reducer)
 max. +80°C

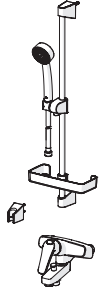
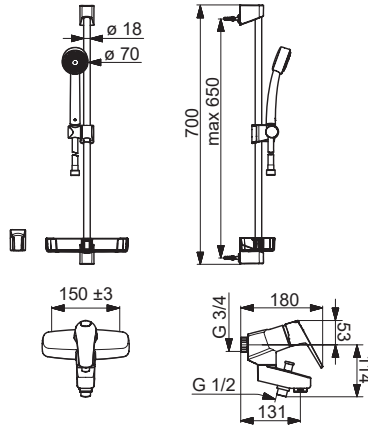

mpi.oras.com/1878G

1879G

I (ISO 3822)
 EN 817, EN 1112, EN 1113
 50 - 1000 kPa
 0.19 l/s (Eco)
 0.33 l/s (300 kPa)
 0.2 l/s (300 kPa w/Reducer)
 160 kPa (0.2 l/s)
 260 kPa (0.3 l/s)
 300 kPa (0.2 l/s w/Reducer)
 max. +80°C

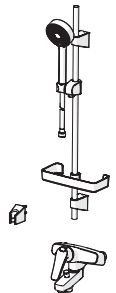
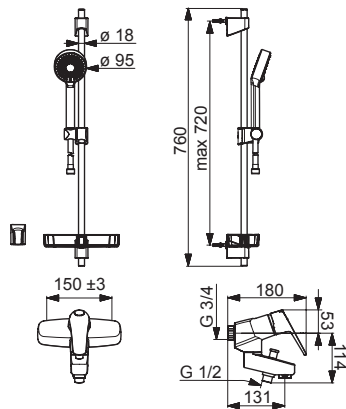

mpi.oras.com/1879G

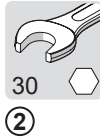
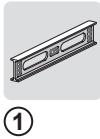
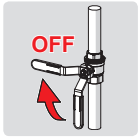

max.
1600 kPa

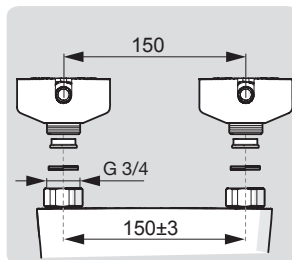
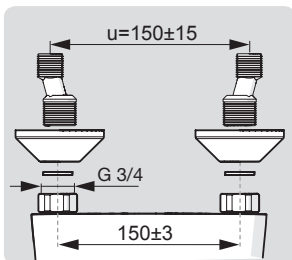
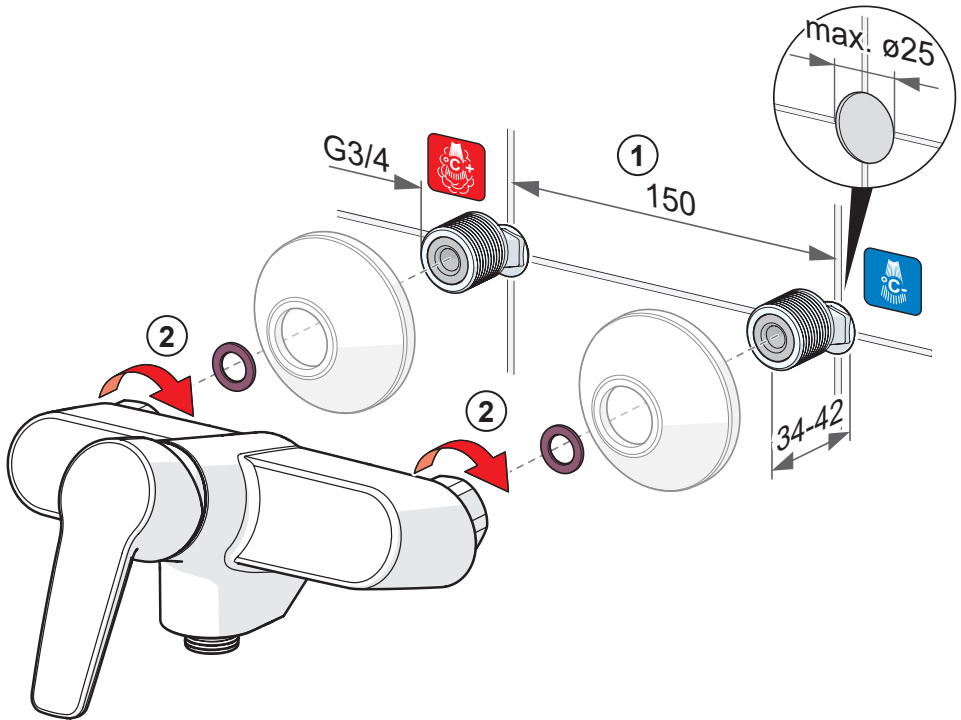

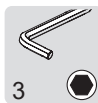

3

②

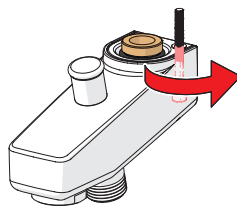
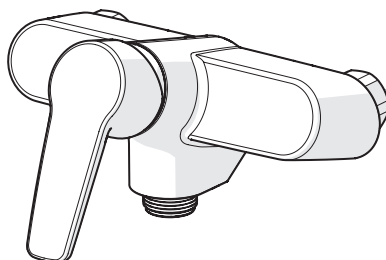

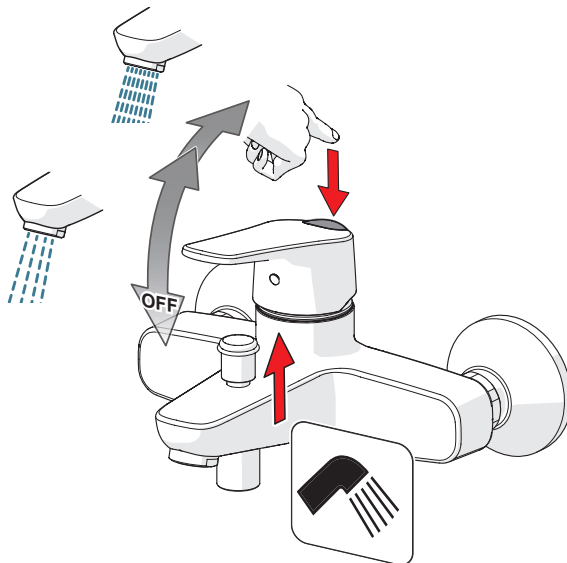
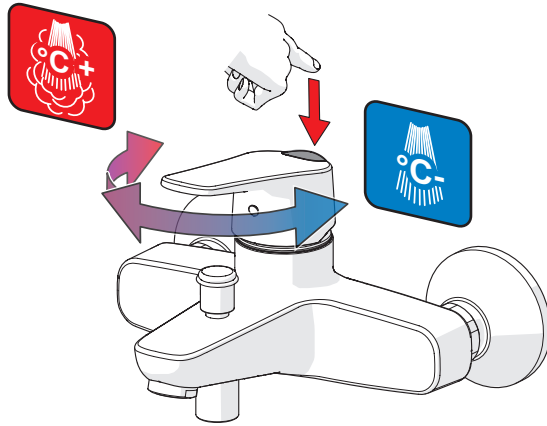

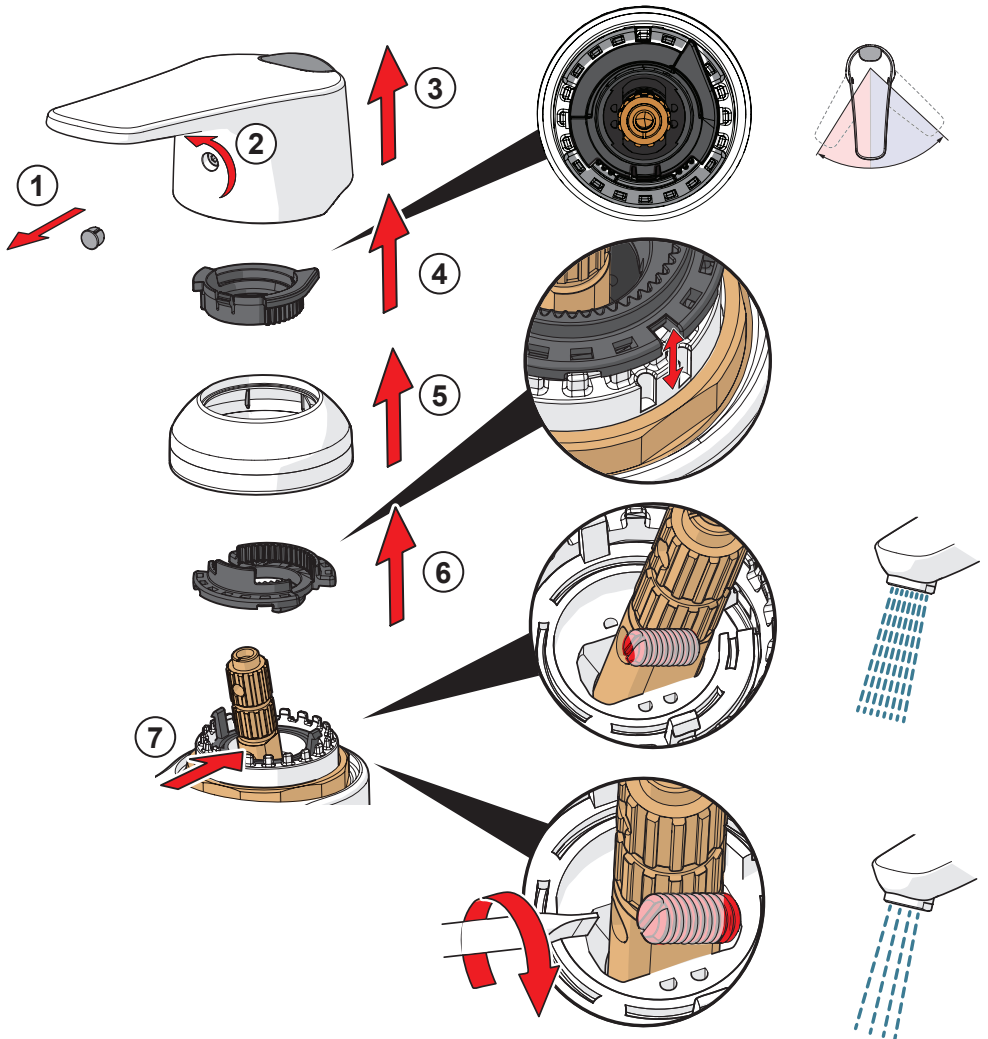
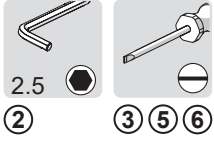
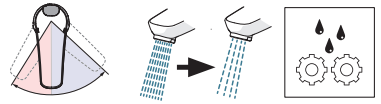



②

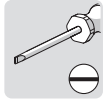

④

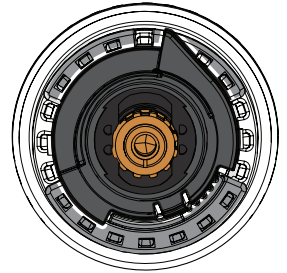
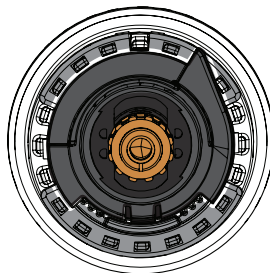
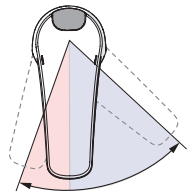
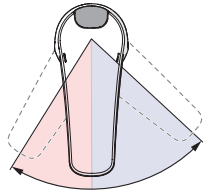
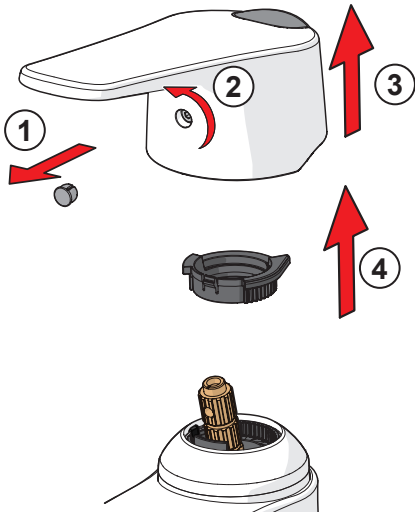

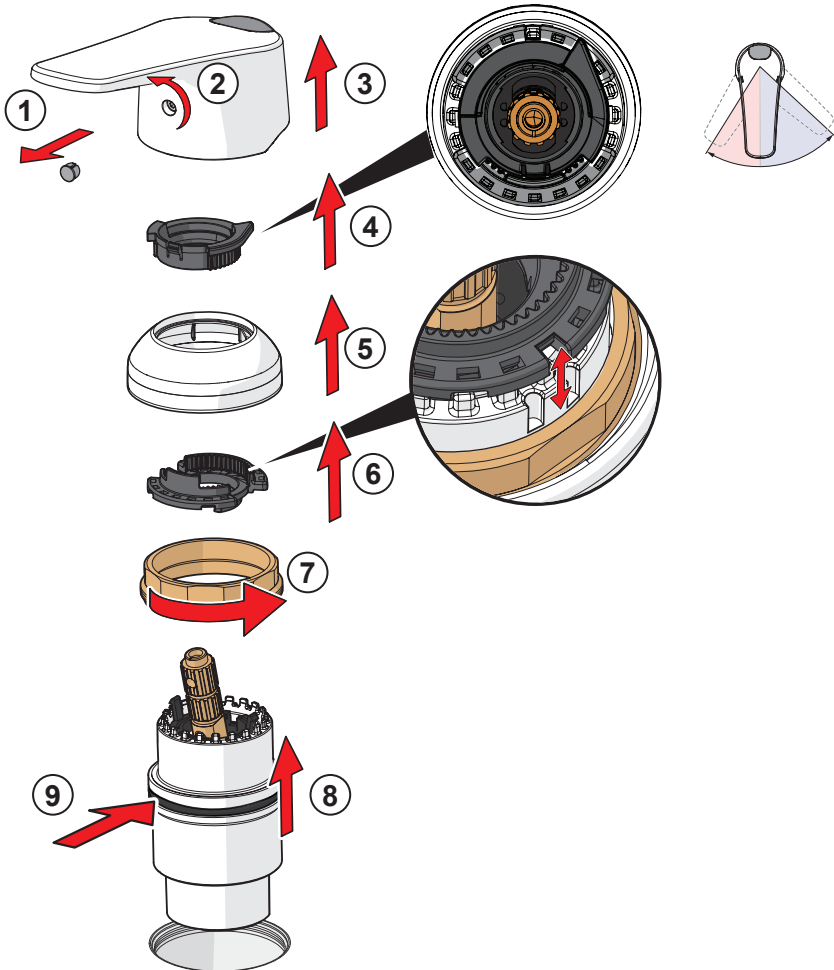
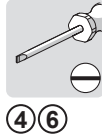
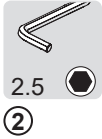
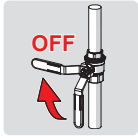



①

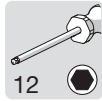

③

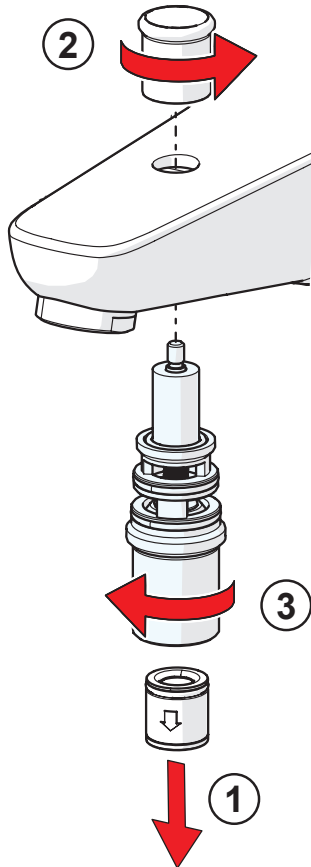

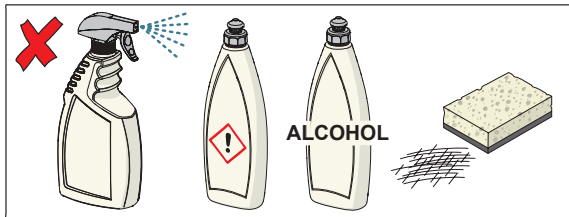
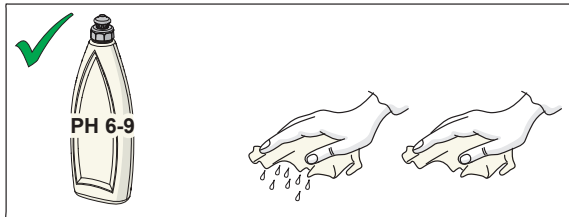
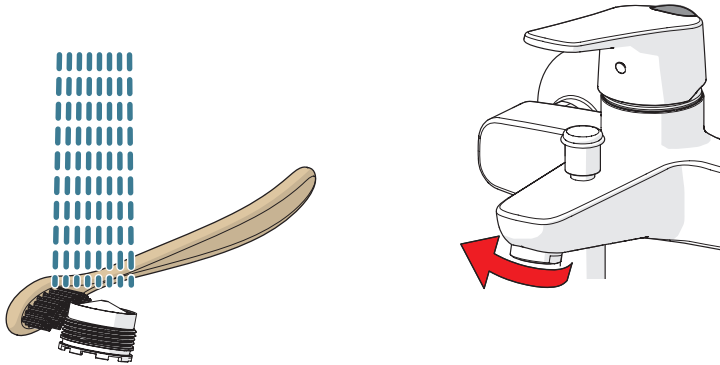
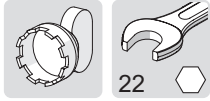

CLEANING.ORAS.COM

About Oras Group

Oras Group is a significant European provider of sanitary fittings: the market leader in the Nordics and a leading company in Continental Europe.

The company's mission is to create the smartest water experiences for everyone and its vision is to become the Perfect Flow Company.

The Group has two strong brands, Oras and Hansa. Oras Group is owned by Oras Invest, a family company, and an industrial owner.

The domicile of Oras Ltd, the parent company of the Group, is located in Rauma, Finland, and the Group has three manufacturing sites: Kralovice (Czech Republic), Olesno (Poland) and Rauma (Finland).

The Group operates with its own staff in 17 markets. Oras Group's net sales were 233.5 million euros in 2021 and at the end of the period the company employed 1255 people.

ORAS Ltd
Isometsäntie 2, P.O. Box 40
FI-26101 Rauma
Tel. +358 2 83 161
Fax +358 2 831 6300
info.finland@oras.com
www.oras.com



943403-06-23